

# FRESE COMPONENTI Dal Ø 16 al Ø 100

# GRUPPO 2

## MANDRINI / Tool holders

### 2A Cono Morse

### 2AF Senza Penola



Gambo	CODICE	PREZZO €	CODICE	PREZZO €
M.T. 2	12.02.002 ●	142,14		
M.T. 3	12.02.003 ●	142,14	12.01.003 ●	249,83
M.T. 4	12.02.004 ●	153,78	12.01.004 ●	249,83
M.T. 5	12.02.005 □	341,14	12.01.005 □	510,67

### 2A/T

### 2AF/T Senza Penola



Gambo	CODICE	PREZZO €	CODICE	PREZZO €
M.T. 3	12.04.003 ●	230,21	12.03.003 ●	378,73
M.T. 4	12.04.004 ●	230,21	12.03.004 ●	378,73
M.T. 5	12.04.005 □	383,93	12.03.005 □	653,54

### 2C Cono Morse

### Serie Lunga Long Type



Gambo	Lunghezza Guida	CODICE	PREZZO €
M.T. 3	175 mm	12.06.175 ●	278,25
M.T. 3	250 mm	12.06.250 ●	369,10

### 2B Gambo Cilindrico

### Cylindrical Shank

Gambo	CODICE	PREZZO €
Ø 20	12.05.020 ●	148,00

### 2BW Weldon

### 2BW/T Weldon Shank



Gambo	CODICE	PREZZO €	CODICE	PREZZO €
Ø 25	12.05.025 ●	152,44		
Ø 32			12.05.032 ●	222,07

### 2D Registrabile

### 2D/T DIN 6237



Gambo	CODICE	PREZZO €	CODICE	PREZZO €
TR-20	12.07.020 ●	301,22		
TR-28	12.07.028 ●	275,68	12.08.028 ●	361,63
TR-36	12.07.036 ▲	352,85	12.08.036 ▲	651,50
TR-48			12.08.048 ▲	728,45

## Penole / Threaded tang

C.M.	Filetto	CODICE	PREZZO €
M.T.3	M.12	14.03.012 ●	27,35
M.T.4	M.16	20.03.016 ●	31,11
M.T.5	M.20	40.03.020 ●	31,11

### MANDRINI/Toolholders 2C

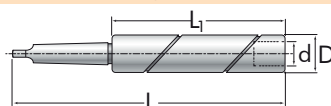

Typo	L	L1	d(H7)	D(h7)
2C 175 mm	277	175	22	40
2C 250 mm	352	250		

## PUNTE / Drills

### 2/C

### 2/L



Ø h8	CODICE	PREZZO €	CODICE	PREZZO €
*11,0	12.14.110 ●	49,44	12.15.110 ●	52,32
*11,5	12.14.115 ●	49,44	12.15.115 ●	52,32
12,0	12.14.120 ●	55,83	12.15.120 ●	59,38
12,2	12.14.122 ●	55,83	12.15.122 ●	59,38
12,5	12.14.125 ●	55,83	12.15.125 ●	59,38
13,0	12.14.130 ●	59,38	12.15.130 ●	62,21
13,5	12.14.135 ●	64,32	12.15.135 ●	67,16
14,0	12.14.140 ●	67,77	12.15.140 ●	71,33
14,5	12.14.145 ●	69,32	12.15.145 ●	72,00
15,0	12.14.150 ●	72,00	12.15.150 ●	75,65
15,1	12.14.151 ●	72,00	12.15.151 ●	75,65
15,5	12.14.155 ●	72,00	12.15.155 ●	75,65
16,0	12.14.160 ●	82,55	12.15.160 ●	84,67
16,5	12.14.165 ●	82,55	12.15.165 ●	84,67
17,0	12.14.170 ●	84,00	12.15.170 ●	86,88
17,5	12.14.175 ●	88,22	12.15.175 ●	92,49
18,0	12.14.180 ●	93,94	12.15.180 ●	97,39
18,5	12.14.185 ●	93,94	12.15.185 ●	97,39
19,0	12.14.190 ●	98,78	12.15.190 ●	102,33
19,25	12.14.193 ▲	102,33	12.15.193 ▲	105,32
19,5	12.14.195 ●	102,33	12.15.195 ●	105,32
20,0	12.14.200 ●	106,71	12.15.200 ●	109,44
21,0	12.14.210 ●	106,71	12.15.210 ●	109,44
22,0	12.14.220 ●	118,55	12.15.220 ●	122,83
23,0	12.14.230 ●	129,21	12.15.230 ●	131,99
24,0	12.14.240 ●	131,99	12.15.240 ●	133,44
25,0	12.14.250 ●	136,17	12.15.250 ●	138,84

\*Da NON impiegare con frese in M.D.

### PUNTE/Drills 2/C - 2/L

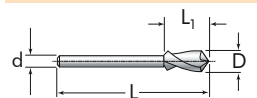

Typo	L	L1	d
2/C	125	30	10
2/L	145	50	

### GUIDE/Pilots 2/F - 2/R

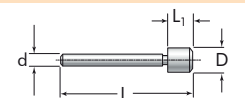

L	L1	d	D(e8)
105	20	10	10 - 52

### MANDRINI/Toolholders 2A-2AF

Frese / Counterbores <= Ø 49

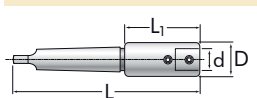

Gambo	L	L1	d(H7)	D(h7)
C.M.2	158			
C.M.3	177	75	22	36
C.M.4	203			
C.M.5	235			

### 2A/T - 2AF/T

Frese / Counterbores >= Ø 50

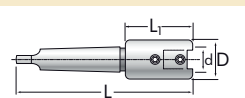

L	L1	d(H7)	D(h7)
185			
211	83	22	48
243			

### MANDRINI/Tool holders 2B

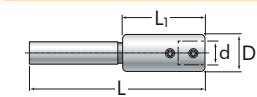

Typo	Gambo	L	L1	d(H7)	D(h7)
B	Cilindrico Ø 20	147			
BW	Weldon Ø 25	135	75	22	36
BW/T	Weldon Ø 32	147	83	22	48

### 2BW - 2BW/T

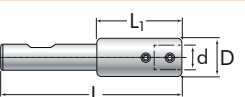

### MANDRINI/Tool holders 2D C.N.

Frese / Counterbores <= Ø 49

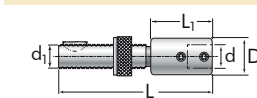

Gambo	L	L1	d(H7)	D(h7)
TR-20	163			
TR-28	170	75	22	36
TR-36	193			
TR-48				

### 2D/T C.N.

Frese / Counterbores >= Ø 50

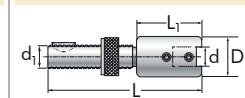

L	L1	d(H7)	D(h7)
180			
201	83	22	48
228			

## GUIDE / Pilots

### 2/F



Ø e8	CODICE	PREZZO €
*10,0	12.16.100 ●	17,97
*10,5	12.16.105 ●	17,97
*11,0	12.16.110 ●	17,97
*11,5	12.16.115 ●	17,97
12,0	12.16.120 ●	17,97
12,5	12.16.125 ●	17,97
13,0	12.16.130 ●	17,97
13,5	12.16.135 ●	17,97
14,0	12.16.140 ●	20,14
14,5	12.16.145 ●	20,14
15,0	12.16.150 ●	20,14
15,5	12.16.155 ●	20,14

### 2/R

Ø e8	CODICE	PREZZO €
16,0	12.16.160 ●	36,51
16,5	12.16.165 ●	36,51
17,0	12.16.170 ●	36,51
17,5	12.16.175 ●	37,08
18,0	12.16.180 ●	37,08
18,5	12.16.185 ●	37,08
19,0	12.16.190 ●	37,08
19,5	12.16.195 ○	47,69
20,0	12.16.200 ○	37,08
20,5	12.16.205 ○	48,56
21,0	12.16.210 ○	37,96
21,5	12.16.215 ○	48,56
22,0	12.16.220 ○	37,96
22,5	12.16.225 ○	50,06
23,0	12.16.230 ○	39,45
23,5	12.16.235 ○	50,06
24,0	12.16.240 ○	39,45
24,5	12.16.245 ○	50,06
25,0	12.16.250 ○	39,45
25,5	12.16.255 ○	51,55
26,0	12.16.260 ○	40,94
26,5	12.16.265 ○	51,55
27,0	12.16.270 ○	40,94
27,5	12.16.275 ○	51,55
28,0	12.16.280 ○	40,94
28,5	12.16.285 ○	51,55
29,0	12.16.290 ○	40,94
29,5	12.16.295 ○	53,66
30,0	12.16.300 ○	43,05
30,5	12.16.305 ○	53,66
31,0	12.16.310 ○	43,05
31,5	12.16.315 ○	54,38
32,0	12.16.320 ○	43,72
32,5	12.16.325 ○	56,50
33,0	12.16.330 ○	45,89
33,5	12.16.335 ○	56,50
34,0	12.16.340 ○	45,89
34,5	12.16.345 ○	56,50
35,0	12.16.350 ○	45,89
35,5	12.16.355 ○	56,50
36,0	12.16.360 ○	45,89
36,5	12.16.365 ○	61,08
37,0	12.16.370 ○	50,47
37,5	12.16.375 ○	64,17
38,0	12.16.380 ○	53,56
38,5	12.16.385 ○	67,05
39,0	12.16.390 ○	56,44
39,5	12.16.395 ○	72,98
40,0	12.16.400 ○	62,37
41,0	12.16.410 ○	81,89
42,0	12.16.420 ○	71,28
43,0	12.16.430 ○	81,89
44,0	12.16.440 ○	71,28
45,0	12.16.450 ○	86,31
46,0	12.16.460 ○	75,71
47,0	12.16.470 ○	88,37
48,0	12.16.480 ○	77,77
49,0	12.16.490 ○	88,37
50,0	12.16.500 ○	77,77
51,0	12.16.510 ○	89,82
52,0	12.16.520 ○	79,16