

INTERCAMBIABILI E COMPONENTI

Ogni albero può essere utilizzata con qualsiasi fresa, purchè dello stesso gruppo.

*=Da NON impiegare con frese in M.D.

INTERCHANGEABLE AND MODULAR

Each arbor can be used with any counterbore, provided of the same group.

*=Not to be used with H.M. cutters

C.M. M.T. Shank	WELDON Weldon Shank
--------------------	------------------------



GR	d Ø Attacco	L ₁ Guida	L Albero	Cono Morse	d2 Ø Weldon	d1 Ø e8	CODICE		PREZZO €						
							ConoMorse	Weldon							
6	6	55	92,5	M.T. 1	12	* 6	60.04.060 ●	60.04.060/W ●	101,26						
						* 6,5	60.04.065 ●	60.04.065/W ●	101,26						
						* 7	60.04.070 ●	60.04.070/W ●	101,26						
						7,5	60.04.075 ○	60.04.075/W ○	117,00						
						8	60.04.080 ●	60.04.080/W ●	101,26						
						8,5	60.04.085 ●	60.04.085/W ●	101,26						
						9	60.04.090 ●	60.04.090/W ●	101,26						
						9,5	60.04.095 ○	60.04.095/W ○	117,00						
						10	60.04.100 ●	60.04.100/W ●	101,26						
						9	9	75	116,5	M.T. 2	16	* 9	90.04.090 ●	90.04.090/W ●	103,49
* 9,5	90.04.095 ●	90.04.095/W ●	103,49												
* 10	90.04.100 ●	90.04.100/W ●	103,49												
10,5	90.04.105 ●	90.04.105/W ●	103,49												
11	90.04.110 ●	90.04.110/W ●	103,49												
11,5	90.04.115 ○	90.04.115/W ○	119,00												
12	90.04.120 ●	90.04.120/W ●	103,49												
12,5	90.04.125 ○	90.04.125/W ○	119,00												
13	90.04.130 ●	90.04.130/W ●	103,49												
13,5	90.04.135 ○	90.04.135/W ○	119,00												
14	90.04.140 ●	90.04.140/W ●	103,49												
14,5	90.04.145 ○	90.04.145/W ○	119,00												
15	90.04.150 ●	90.04.150/W ●	103,49												
14	14	90	143	M.T. 3	20							* 14	14.04.140 ●	14.04.140/W ●	150,97
												* 14,5	14.04.145 ○	14.04.145/W ○	166,00
						* 15	14.04.150 ●	14.04.150/W ●	150,97						
						16	14.04.160 ●	14.04.160/W ●	150,97						
						17	14.04.170 ●	14.04.170/W ●	150,97						
						18	14.04.180 ●	14.04.180/W ●	150,97						
						19	14.04.190 ○	14.04.190/W ○	166,00						
						20	14.04.200 ●	14.04.200/W ●	150,97						
						21	14.04.210 ●	14.04.210/W ●	150,97						
						20	20	90	147	M.T. 3	20	* 20	20.04.200 ●	20.04.200/W ●	158,18
												* 21	20.04.210 ●	20.04.210/W ●	158,18
22	20.04.220 ●	20.04.220/W ●	158,18												
23	20.04.230 ●	20.04.230/W ●	158,18												
24	20.04.240 ●	20.04.240/W ●	158,18												
25	20.04.250 ●	20.04.250/W ●	206,88												
20	110	168,5	M.T. 4	20	26		20.04.260 ●	20.04.260/W ●	206,88						
					27		20.04.270 ●	20.04.270/W ●	206,88						
					28		20.04.280 ○	20.04.280/W ○	232,00						
					30		20.04.300 ●	20.04.300/W ●	206,88						
					32		20.04.320 ●	20.04.320/W ●	208,41						

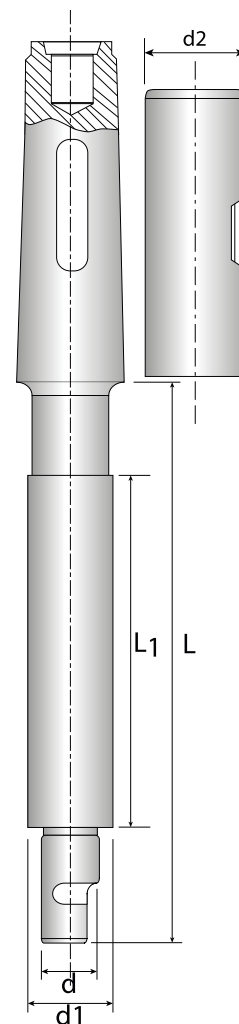

Penole / Threaded tang				
Filetto	C.M.	CODICE	PREZZO €	
	M.6	M.T. 1	60.03.006 ●	19,94
	M.10	M.T. 2	90.03.010 ●	24,03
	M.12	M.T. 3	14.03.012 ●	28,17
	M.16	M.T. 4	20.03.016 ●	32,04

