

### INTERCAMBIABILI E COMPONENTI

Ogni albero può essere utilizzata con qualsiasi fresa, purchè dello stesso gruppo.

\*=Da NON impiegare con frese in M.D.

### INTERCHANGEABLE AND MODULAR

Each arbor can be used with any counterbore, provided of the same group.

\*=Not to be used with H.M. cutters

C.M. M.T. Shank		WELDON Weldon Shank	
			
CODICE	CODICE	PREZZO €	
Cono Morse	Weldon		
30.04.300 ●	30.04.300/W ●	256,05	
30.04.320 ●	30.04.320/W ●	256,05	
30.04.350 ●	30.04.350/W ●	263,00	
30.04.360 ●	30.04.360/W ●	263,00	
30.04.380 ●	30.04.380/W ●	284,69	
30.04.400 ●	30.04.400/W ●	284,69	
30.04.420 ●	30.04.420/W ●	320,24	
30.04.450 ●	30.04.450/W ●	320,24	

GR	d Ø Attacco	L <sub>1</sub> Guida	L Albero	Cono Morse	d2 Ø Weldon	d1 Ø e8
30	30	135	205,5	M.T. 4	25	* 30
						32
						35
						36
						38
						40
						42
						45

40	40	175	256	M.T. 5	32	* 40
						42
						45
						46
						47
						48
						50
						52
						54
						56
						58
						60
						62

40.04.400 ○	40.04.400/W ○	520,00
40.04.420 ●	40.04.420/W ●	487,06
40.04.450 ●	40.04.450/W ●	679,99
40.04.460 ●	40.04.460/W ●	679,99
40.04.470 ○	40.04.470/W ○	705,00
40.04.480 ●	40.04.480/W ●	679,99
40.04.500 ●	40.04.500/W ●	679,99
40.04.520 ○	40.04.520/W ○	710,00
40.04.540 ●	40.04.540/W ●	679,99
40.04.560 ○	40.04.560/W ○	770,00
40.04.580 ●	40.04.580/W ●	738,33
40.04.600 ○	40.04.600/W ○	830,00
40.04.620 ●	40.04.620/W ●	799,82

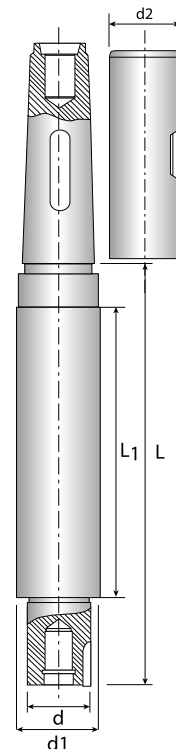

MISURE INTERMEDIE A RICHIESTA / Intermediate sizes on demand

\*=Da NON impiegare con frese in M.D. / Not to be used with H.M. cutters

Penole / Threaded tang				
	Filetto	C.M.	CODICE	PREZZO €
	M.16	M.T. 4	20.03.016 ●	32,04
	M.20	M.T. 5	40.03.020 ●	32,04

